

# INSTUCTIUNI INSTALARE

## Descriere

A. Buton apasa montat superior

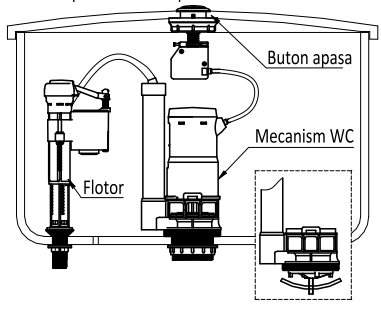

B. Buton apasa montat lateral

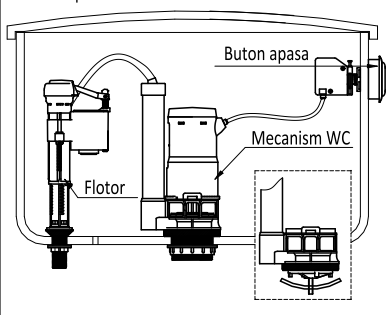

C. cu maner

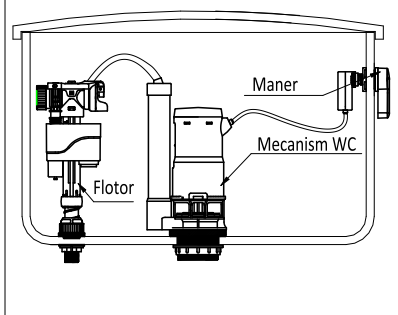

## Pasi

- ▲ I, Trageți apa wc in ideea de a gozi rezervorul, si scoateti vechile robinet flotor si mecanism WC

### II, Instalarea robinetului flotor

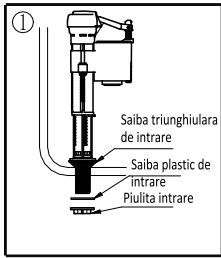

Scoateti saiba si piulita de intrare. Introduceti surubul de intrare in gaura de intrare a rezervorului, re-asamblati saiba si piulita de intrare. Reglati flotorul si strangeti piulita

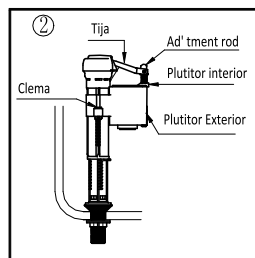

Reglarea nivelului apei: Scoateti cleva și reglati plutitorul exterior in pozitia corectă. Glosati opritor și rotiți tija de reglare pentru reglaj pe verticală.

### III, Instalarea mecanismului

#### 1. Mecanism wc pentru vas wc 2 piese

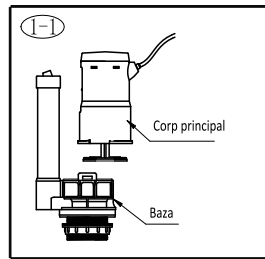

Invertiti corpul principal pana iese din baza.

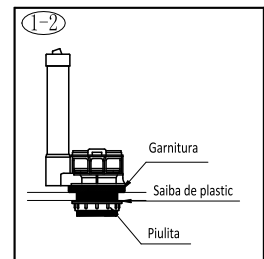

Scoateti piulita si saiba de plastic, introduceti baza in gaura de intrare si asezati-o corespunzator, re-asamblati saiba de plastic, strangeti piulita pana aduce garnitura aproape de rezervor

#### 2. Mecanism wc pentru vas wc -1 piesa

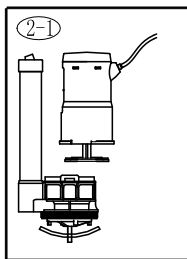

Invertiti corpul principal pana iese din baza.

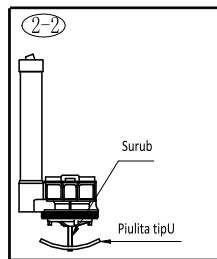

Invertiti piulita tip U ca pe un surub

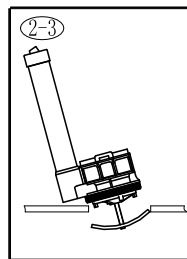

Inclinati mecanismul si apasati-l in gaura rezervorului. Reglati directia bazei.

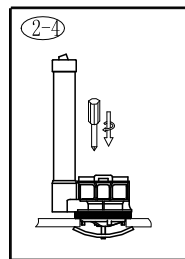

Strangeti piulita tip U printr-o Surubelina, saiba de etansare să atingă strâns rezervorul

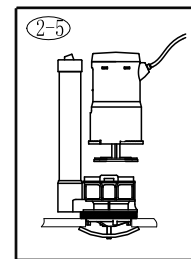

Puneti corpul principal in baza

### IV, Instalarea tevii de reumplere

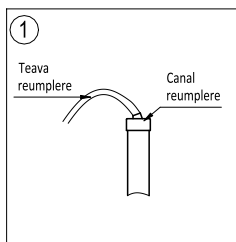

Introduceti unul din capetele tevii de reumplere in flotor iar celalat in canal de umplere loc

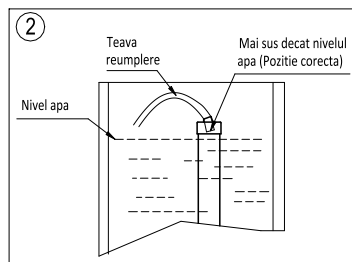

Notes: The re-fill tube could not insert deeper than water level

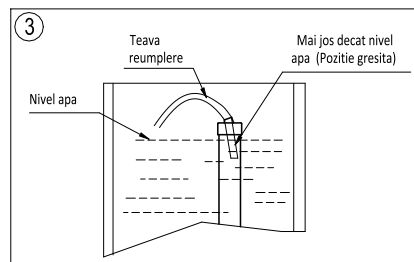

## v, Instalarea buton apasare/maner

### 1. Montare sus buton apasare

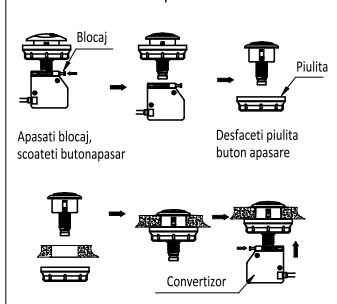

Introduceti buton apasare in capac rezervor superior, insurubati si strangeti piulita. Apasati blocaj convertizor si impingeti jos buton apasare

### 2. Montare laterala buton apasare

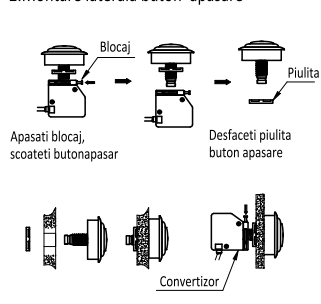

Introduceti buton apasare in capac rezervor lateral, insurubati si strangeti piulita. Apasati blocaj convertizor si impingeti jos buton apasare

### 3. Maner

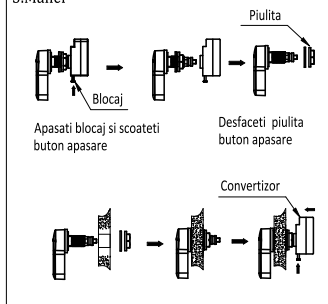

Introduceti buton apasare in capac rezervor lateral, insurubati si strangeti piulita. Apasati blocaj convertizor si impingeti jos

## VI, Reglare volum

### 1, Reglare volum jumatate tragere

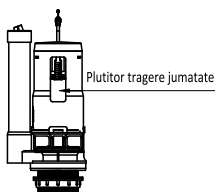

Pozitia plutitorului tragere la jumatate regleaza jumatate de volum evacuare. Cel mai mare volum de apa evacuat este cand Plutitorul jumatate este la fund, Cel mai mic volum de apa evacuat este cand plutitorul jumatate este la varf

### 2, Reglare volum tragere totala

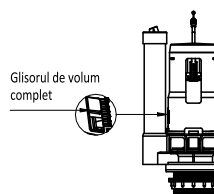

Marimea zonei de deschidere defineste volumul complet. Muta in sus cursorul de volum complet pentru a face deschiderea volumului mai mare si vice versa.

## Probleme

### 1, Mecanism

NO.	Probleme	Posibile cauze	Solutii
1	Scurgeri de apa	Flotor fixat gresit	Strangeti tare
2	Scurgeri de apa la mecanism	Defecte in mecanism sau garnitura stricata	Schimbati mecanismul sau garnitura
3	Prea multa/putina apa la actionare mecanism	Plutitor tragere jumatate si piesa reglabila in pozitie gresita	Reglati corespunzator
4	Mecanismul nu livreaza apa suficienta	Butonul tijei prea scurt	Reglati lungimea tijei

### 2. Flotor

No.	Probleme	Posibile cauze	Solutii
1	Flotorul nu umple rezervorul	Alimentarea este infundata sau flotorul are pozitie improprie	Curatati alimentarea, reglati flotorul
2	Rezervorul se umple prea mult sau partial	Pozitie incorecta a flotorului	Desfaceti opritorul, ridicati ori coborati plutitorul si rotiti corespunzator surubul de reglaj, fixati opritorul si surubul de reglaj.
3	Pierderi de apa la intrare	Saiba de intrare nu este bine stransa sau vasul wc este deformat	Strangeti piulita sau reparati vasul wc.

Pastrati instructiunile pentru montari viitoare.